

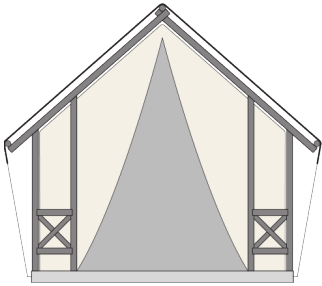

# Safari S BASIC

**Facade:**



**Layout:**

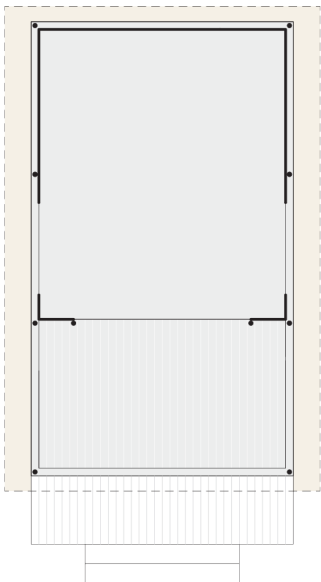

**A1 GENERAL**

Lenght interior/exterior	3,76/6,3
Width interior/exterior	3,19/4,09
Height interior/exterior	3,15/3,76
Lenght	5,9
Width	2,4
Height	2,33
Area	18,12
Number of beds	-
Number of bedrooms	-
Number of bathrooms	-
Kitchen	-
Transport lenght	5,68
Transport width	2,28
Transport height	2,33
Dimension terrace	3,19x1,91

**B1 CHASSIS**

Single inflatable wheels	O
Wheels for cointainer	O
Detachble hook	O
Leveling Feet	X
Anchoring Kit - Steel rod	O
Anchoring Kit - Steel ancor	O
Powder coated steel chassis	X

**B2 FLOOR**

Vynil flooring	X
Moisture resistant CTB-H flooring 19 mm	X

**B3 EXTERIOR WALLS**

PVC transport protection	X
Sturdy round wooden beams fi 100 mm	X
Powder coated steel connectors	X
Roof canvas Sattler Complain 641 670g/m2 (FR)	X

Roof canvas TenCate Campshield FR1 420g/m2 (FR)	O
Interior canvas TenCate Cotton KD24 340g/m2	X
Interior canvas TenCate Campshield FR2 290g/m2 (FR)	O
Window with mosquito net	X
Internal canvas rolo	X
External cristal PVC rolo with Vecro tape	X
Front entrance opening secton on zipper	X
Side wall opening sections on zipper	O
Mosquito net for entrance opening	O
Pad lock system	X
Master key for pad lock system	O
Winter cover	O
Stick for door zipper	X

#### **E1 EXTERIOR EQUIPMENT**

Terrace from Larchwood	X
Extended terrace from Larchwood	O
Stairs on the whole lenght	O
Table with chairs	O
Lounge furniture with two chairs and coffe table	O
Sun loungers (2 pcs)	O

### Legal Notice

The information on this website is provided "as is" and without warranty of any kind, expressed or implied, including (but not limited to) any implied warranties of merchantability and non-infringement of third party rights. While the information provided is believed to be accurate, it may include errors or inaccuracies. In no event shall Adria Home be liable to any person for any special, indirect or consequential damages relating to this material, unless caused by gross negligence or intentional misconduct. The purpose of this website is illustrative. The website may show visuals which may include some elements not belonging to the standard equipment or portray products which may not be available in all markets. Products may change in terms of technical specification and commercial details and in relation to specific regulations. You are advised to always contact your selected Adria representative to obtain all detailed information prior to purchasing.

### Copyright

Copyright © Adria Home Ltd., ?rnatelj, Slovenia 2019-20. All rights reserved. The text, images, graphics, sound files, animation files, video files, and their arrangement on the Adria Home website are all subject to copyright and other intellectual property protection. These objects may not be copied for commercial use or distribution, nor may these objects be modified or reposted to other sites. Adria Home website may contain images whose copyrights are attributable to third parties.



Adria Home Ltd.  
Kanižarica 41, SI-8340 ?rnatelj, Slovenija, Tel: +386 (0) 7 35 69 100, E-mail: info@adria-mobilehome.com  
[www.adria-mobilehome.com](http://www.adria-mobilehome.com) , [www.adria-holidays.net](http://www.adria-holidays.net)

#AdriaHome  
#AdriaGlamping

