

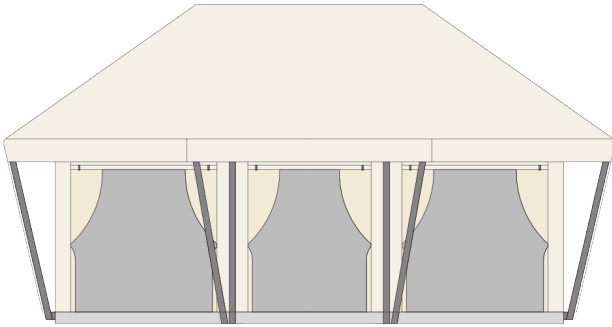

# Boutique XL FAMILY

**Facade:**



**Layout:**

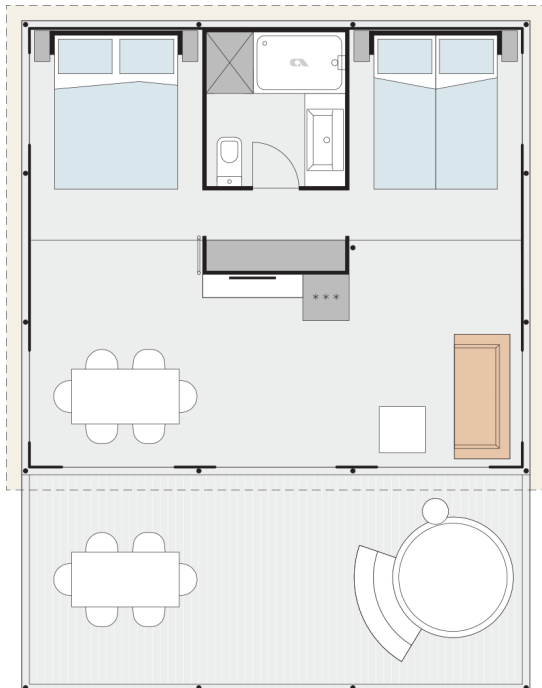

**Layout 2:**

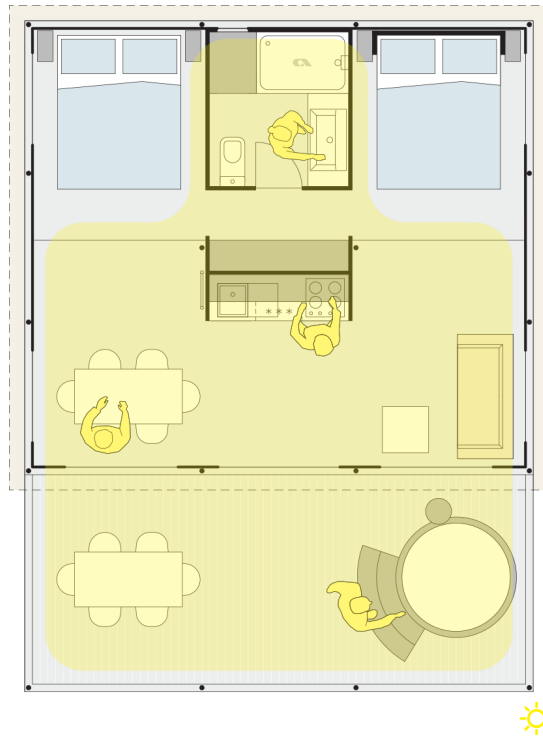

**A1 GENERAL**

Number of beds	6
Number of bedrooms	3
Number of bathrooms	1
Bathroom	X
Kitchen	-
Loft bedroom	X
Length interior/exterior	6,6/7,62
Width interior/exterior	5,9/6,9
Height interior/exterior	3,89/4,67
Area	39+7
Transport length	5,9
Transport width	2,3
Transport height	2,55

**B1 CHASSIS**

Powder coated steel chassis	X
Single inflatable wheels	O
Wheels for container	O
Detachable hook	O
Leveling Feet	X
Anchoring Kit - Steel rod	O
Anchoring Kit - Steel anchor	O

**B2 FLOOR**

Vynil flooring	X
Moisture resistant CTB-H flooring 19 mm	X

**B3 EXTERIOR WALLS**

PVC transport protection	X
Chassis cover PVC 15cm	O
Sturdy wooden beams fi 80mm	X
Chassis cover Campshield FR1 15CM	X
Chassis cover PVC 50cm	O
Chassis cover PVC 35cm	O

**Boutique XL FAMILY**

Chassis cover Campshield FR1 35cm	O
Chassis cover Campshield FR1 50cm	O
100% aluminium foldable pole construction	O
Powder coated steel connectors	X
Roof canvas Sattler Complain 641 670g/m2 (FR)	O
Roof canvas TenCate Solair KA46 420g/m2	O
Roof canvas TenCate Campshield FR1 420g/m2 (FR)	X
Interior canvas TenCate Cotton KD24 340g/m2	O
Interior canvas TenCate Campshield FR2 290g/m2 (FR)	X
Window with mosquito net	X
Internal canvas rolo	X
External cristal PVC rolo with Vecro tape	X
Front entrance opening section on zipper	X
Side wall opening sections on zipper	O
Mosquito net for entrance opening	X
Pad lock system	X
Master key for pad lock system	O
Winter cover	O

**C0 INTERIOR**

Textile Combination 1	TENT
Furnishing Decor	GOLD CRAFT OAK
Cushions in living room	O
Cushions in bedrooms	O
Bedspread in master bedroom	O
Interior doors 25mm	X
Interior partition walls	X
Partition curtains	X
Mosquito net for beds	O

**C1 LIVING ROOM**

Sofa	X
Sofa bed extendable	O
Sofa footstool	O
Dinning table	X
Coffee table	O

**Boutique XL FAMILY**

Transparent glass for dining table	O
Chairs	X
TV cupboard	X
Mirror	X
Fire extinguisher	O
Fire blanket	O
Smoke detector	O

**C3 MASTER BEDROOM**

Double bed with slatted bed base	160x200
Foam mattresses (25 kg/m <sup>2</sup> )	X
Foam mattresses (35 kg/m <sup>2</sup> )	O
Topper for mattresses	O
Upholstered headboard	X
Bedside tables	X
Wardrobe	X
Safe in master bedroom	O
Upholstered bed	X
Ottoman upholstered bed	O
Ottoman bed with wooden upholstery	O
Wooden bed upholstery	O

**C4 CHILDREN BEDROOM**

Single beds with slatted bed base	2 x 80x200
Foam mattresses PN25	X
Foam mattresses HR35	O
Topper for mattresses	O
Bunk bed	O
Upholstered headboard	X
Bedside tables	X
Wardrobe	X
Upholstered bed	X
Ottoman bed with wooden upholstery	O
Ottoman upholstered bed	O
Wooden bed upholstery	O

**C5 CHILDREN BEDROOM 2**

Safety net for loft bedroom	O
Single beds with slatted bed base	160x200
Foam mattresses PN25	X
Foam mattresses HR35	O
Topper for mattresses	O
Metal ladder with wooden holder	X
Safety fence	X
Internal tent for loft bedroom	O

**C6 BATHROOM**

Shower cabin	120x80
Shower sliding doors with security glass	X
Shower PVC wall	X
Shower rail with sliding shower holder	X
Wash-stand with mixer tap	X
Mirror	X
Ceramic toilet with toilet seat	X
Ceramic Toilet tank with saving function	X
Toilet roll holder	X
Hangers	X
Hairdryer	O

**D1 WATER AND GAS**

External connector to water facilities with	X
PVC water pipes Speedfit®	X
Central waste water outlet	O
Water filter	O
Electrical water heater 80l	X

**D2 ELECTRICITY**

Flush mounted installations, sockets and switches	X
External connector 16A, 250V, 2P+E	X
External connection 16A, 400V, 3P+N+E	O
External connection 32A, 250V, 2P+E	O

**Boutique XL FAMILY**

External connection 32A, 400V, 3P+N+E	O
External socket under chassis	O
Reading LED lights in all rooms	X
Ambiental LED lightning in living room and slepping rooms	X
Extractor fan in bathroom	X
TV socket	X
USB socket	X
UTP socket	O

**D3 MULTIMEDIA**

TV holder	O
TV holder with double fold function	O
LED TV 32 inch	O
Adria Bluetooth sound system	O

**D4 HEATING AND COOLING**

Air-conditioning - mono split	O
Electrical heater in living room	O
Electrical heater in bedrooms	O
Electrical towel heater in bathroom	O
Insulated water pipes with electrical heating	O
Electrical underfloor heating system Ebecco ® in all rooms	O

**E1 EXTERIOR EQUIPMENT**

Canopy over entrance	X
Covered terrace from Larchwood	O, 6,6x2,74
Terrace from Larchwood	O
Stairs on the whole lenght	O
Table with chairs	O
Lounge furniture with two chairs and coffe table	O
Sun loungers (2 pcs)	O

**C2 KITCHEN**

Selfstanding grey fridge with freezer 217l	X
--	---

**Legal Notice**

The information on this website is provided "as is" and without warranty of any kind, expressed or implied, including (but not limited to) any implied warranties of merchantability and non-infringement of third party rights. While the information provided is believed to be accurate, it may include errors or inaccuracies. In no event shall Adria Home be liable to any person for any special, indirect or consequential damages relating to this material, unless caused by gross negligence or intentional misconduct. The purpose of this website is illustrative. The website may show visuals which may include some elements not belonging to the standard equipment or portray products which may not be available in all markets. Products may change in terms of technical specification and commercial details and in relation to specific regulations. You are advised to always contact your selected Adria representative to obtain all detailed information prior to purchasing.

**Copyright**

Copyright © Adria Home Ltd., ?nomelj, Slovenia 2019-20. All rights reserved. The text, images, graphics, sound files, animation files, video files, and their arrangement on the Adria Home website are all subject to copyright and other intellectual property protection. These objects may not be copied for commercial use or distribution, nor may these objects be modified or reposted to other sites. Adria Home website may contain images whose copyrights are attributable to third parties.



Adria Home Ltd.  
Kanižarica 41, SI-8340 ?nomelj, Slovenija, Tel: +386 (0) 7 35 69 100, E-mail: info@adria-mobilehome.com  
[www.adria-mobilehome.com](http://www.adria-mobilehome.com) , [www.adria-holidays.net](http://www.adria-holidays.net)

#AdriaHome  
#AdriaGlamping

